

Installation Guide

Step - 1

Test Your Unit

- 1-Create a small square in XCS or LightBurn
- 2-'Frame' the square to be sure your machine is **not sounding any alarms** and running correctly.



It is always a good idea to test your machine *before doing any work or maintenance!* It may help save time looking in the wrong place for an issue that existed before.

All steps are the same for Pro and NonPro except NonPro doesn't have a limit switch harness

Step - 2

- 1-Turn your laser **OFF**
- 2-Carefully Cut Wire Ties Off Wire Harness

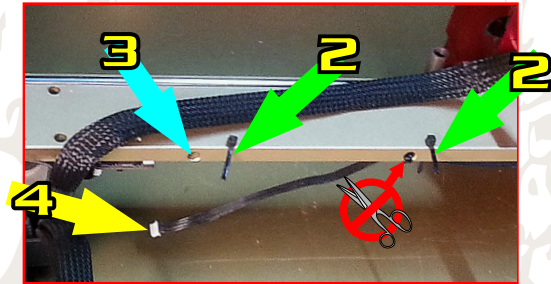

- 3-Cut the End Wire Tie Off Limit Switch Harness
- 4-Unplug Limit Switch Harness

Step - 3

- 1-Slide 2 large clips on the loose end of the limit switch harness.
- 2-Slide 1 large clip on the limit switch cable between wire ties.

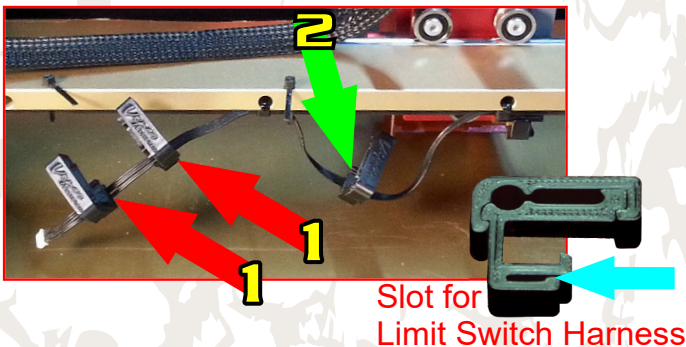

Step - 4

- 1-Hook the Bottom of each Clip on to the top rail.
- 2-Push each Clip on to the top rail until they snap into place.

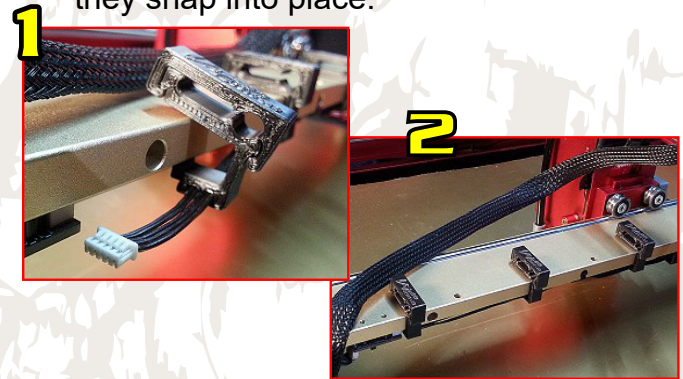

Step - 5

- 1-Plug the Limit Switch Harness Back In.
- 2-Slide the End Clip over against the Limit Switch Plug-In to hold it in place.

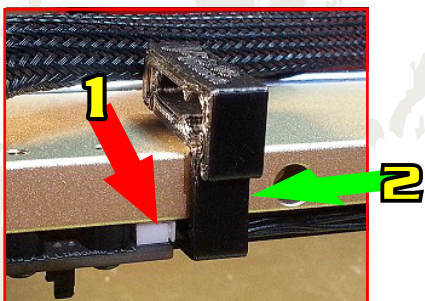

Step - 6

- 1-Place the wire harness into the oval slots in the clips and close all of the clips.



- 2-Move the laser head back and forth **By Hand** to be sure there is enough slack in the cable.

Installation Guide

Step - 7

The 2 Small Clips are Not Needed on NonPro Models

- 1- Unplug the limit switch harness on the far end.
- 2- Slide 1 small clip on the loose end of the limit switch harness.
- 3- Slide 1 small clip on the limit switch harness in between the last 2 wire ties.

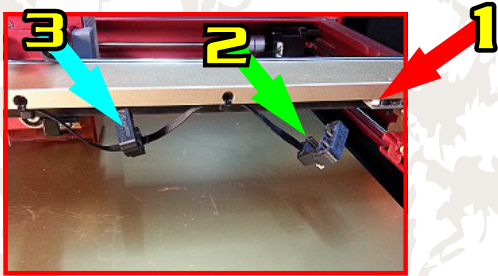

Step - 8

- 1- Push both clips on to the rail until they snap into place.
- 2- Slide the End Clip over against the Limit Switch Plug-In to hold it in place.

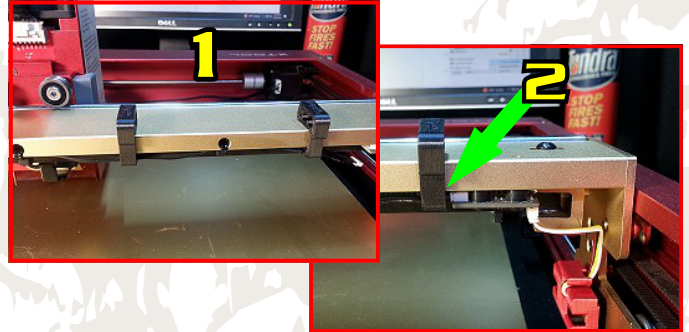

Step - 9

- 1- Put air hose through hole at top of head and connect it to your air assist nozzle.
- 2- Hold the air hose next to the center clip.
- 3- Move the laser head back and forth **By Hand** to be sure there is enough slack in the air hose.

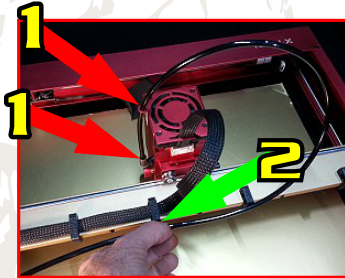

Step - 10

- 1- Open each clip one at a time to insert the air hose then close the clip to secure it.

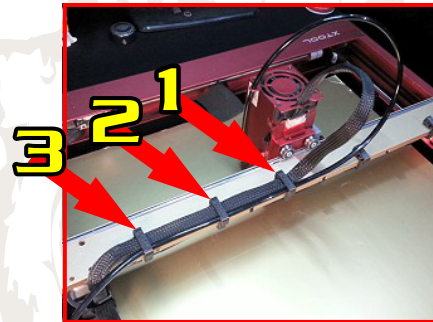

Step - 11

- 1- Turn Power Back On and Test Your Unit

Enjoy Your New Clips!

Feel free to contact me
if you have any questions

Doug Brown
dbrown@viperdesigned.com

